

# Balancing Act

## Boulder Municipal Airport

From the beginning, Balancing act has been a direct response to the need for community benefit in Boulder's regional airport. The Terminal reimagining has become a perfect balance of the factors that make it the community that it is. Pilots and the Boulder community can now come together to enjoy a space that has purpose for everyone. For the pilots, there are private spaces to prep for flights and conduct trainings. For the civic community there is a restaurant and a large hangar event space. The building structure shows balance by both separating the private pilot and civic spaces and also bringing them together in the center atrium. The main structural beams use both tension and compression, with connection points meant to reflect the fragility and Ingenuity that allows us to achieve artificial flight. The Balancing Act is a bringing together of communities and a celebration of the ingenuity of flight, all while maintaining the balance with our natural environment.

A balance between **Communities**

A balance between **Ingenuity** and **Natural Law**

A balance between **Flight** and the **Environment**

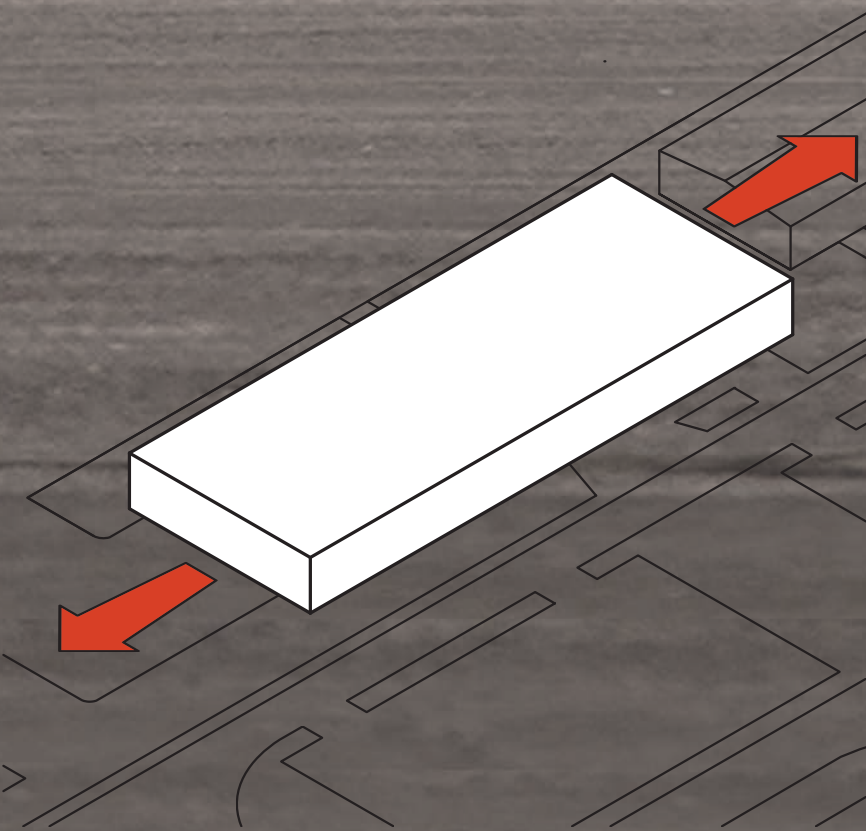
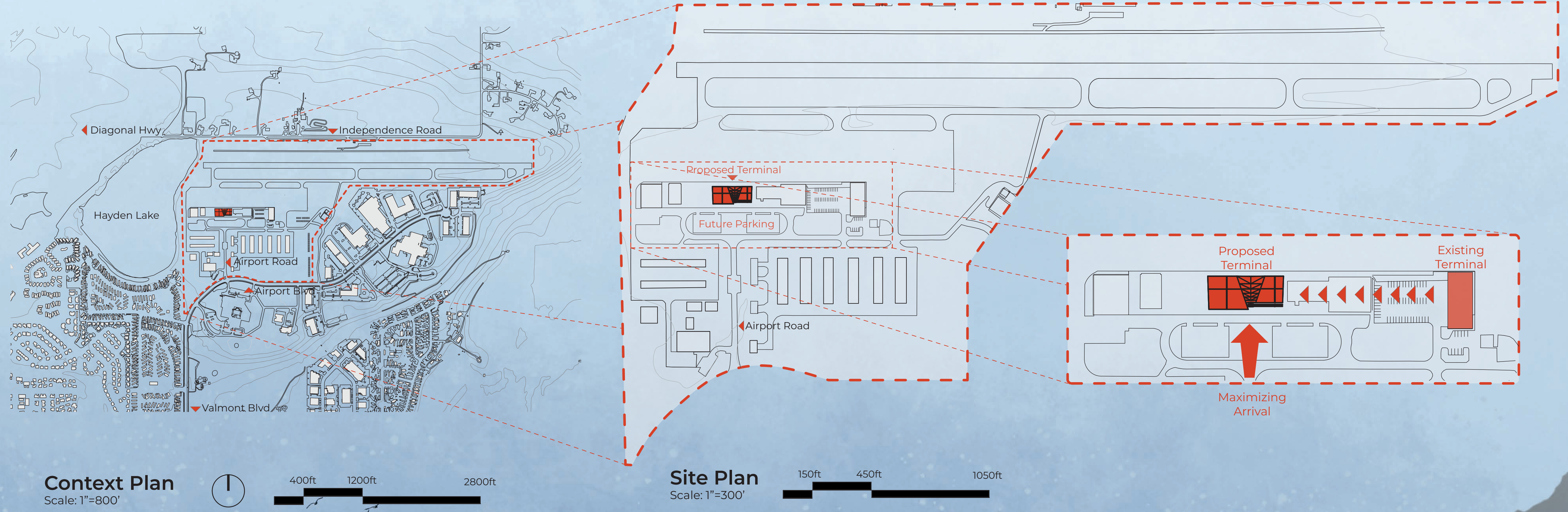

**Expanded Area**

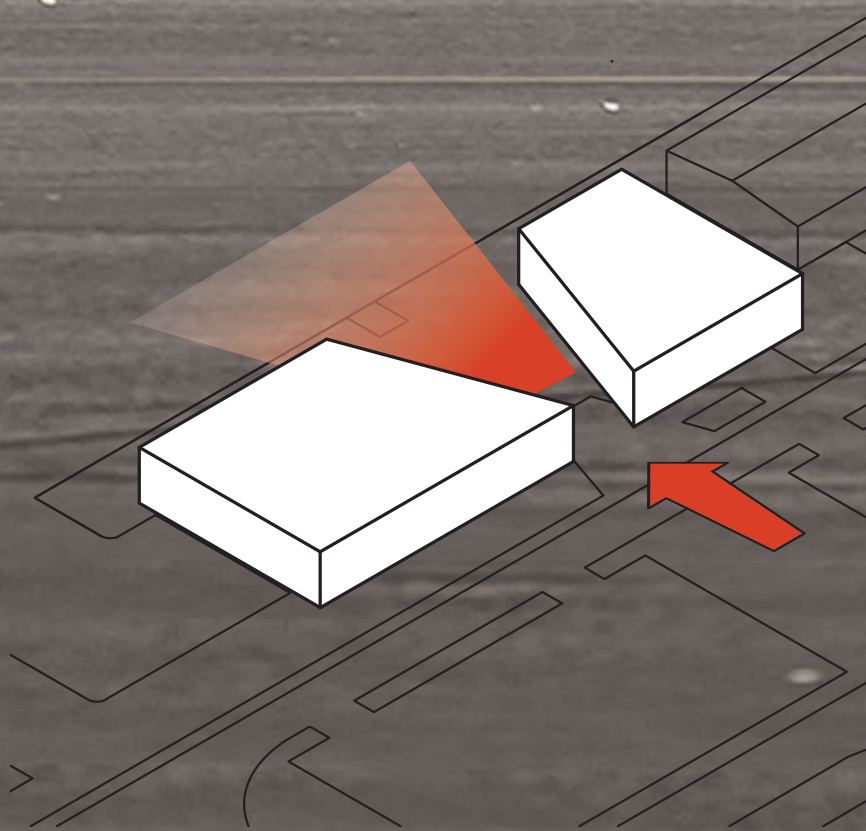

**Take in the View**

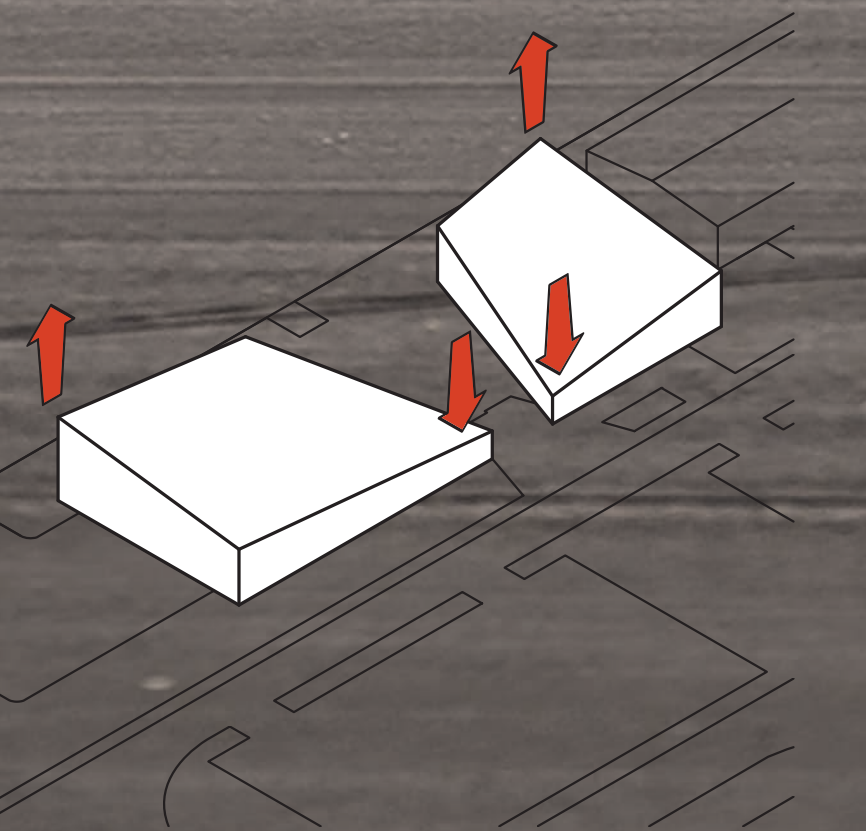

**Angle for Solar Collection**

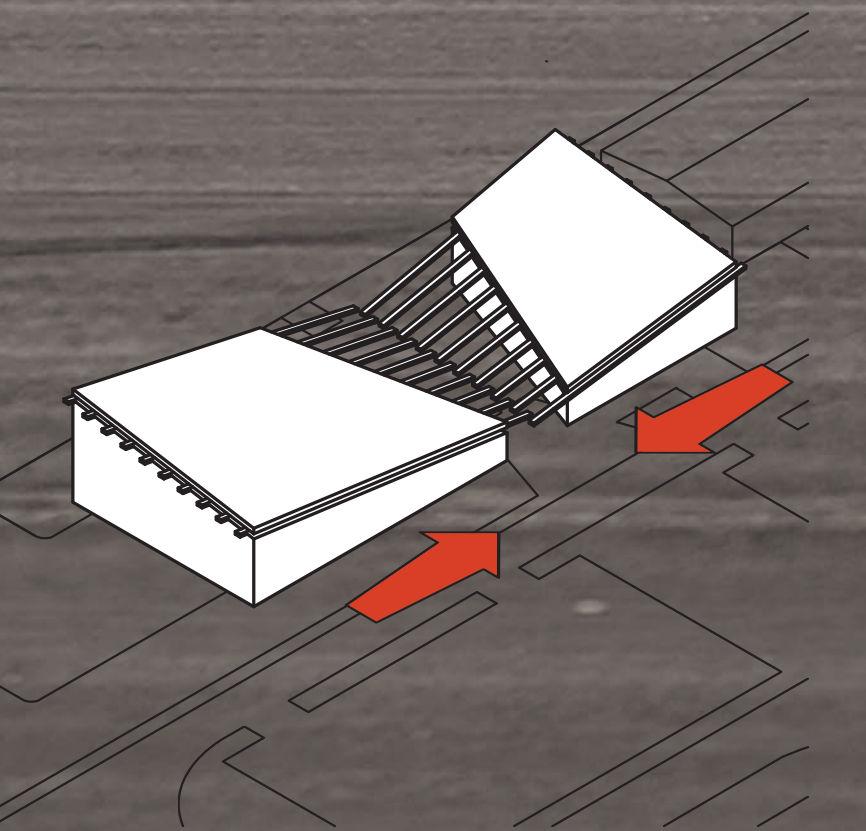

**Reconnection**

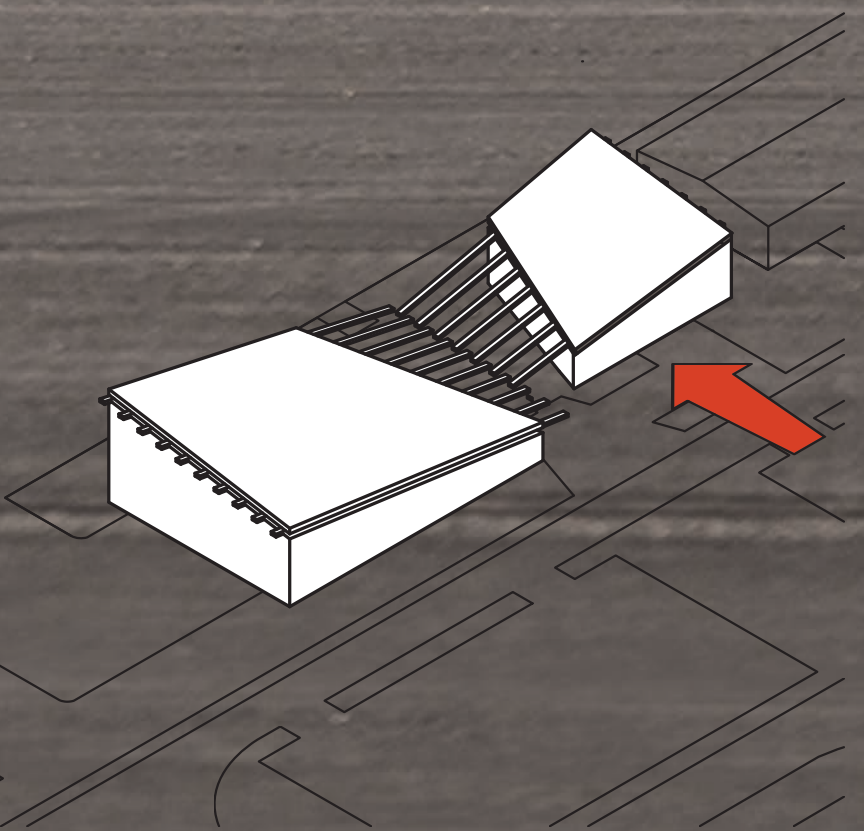

**Creating an Arrival**

### Main Level Floorplan

Scale: 1/16"=1'

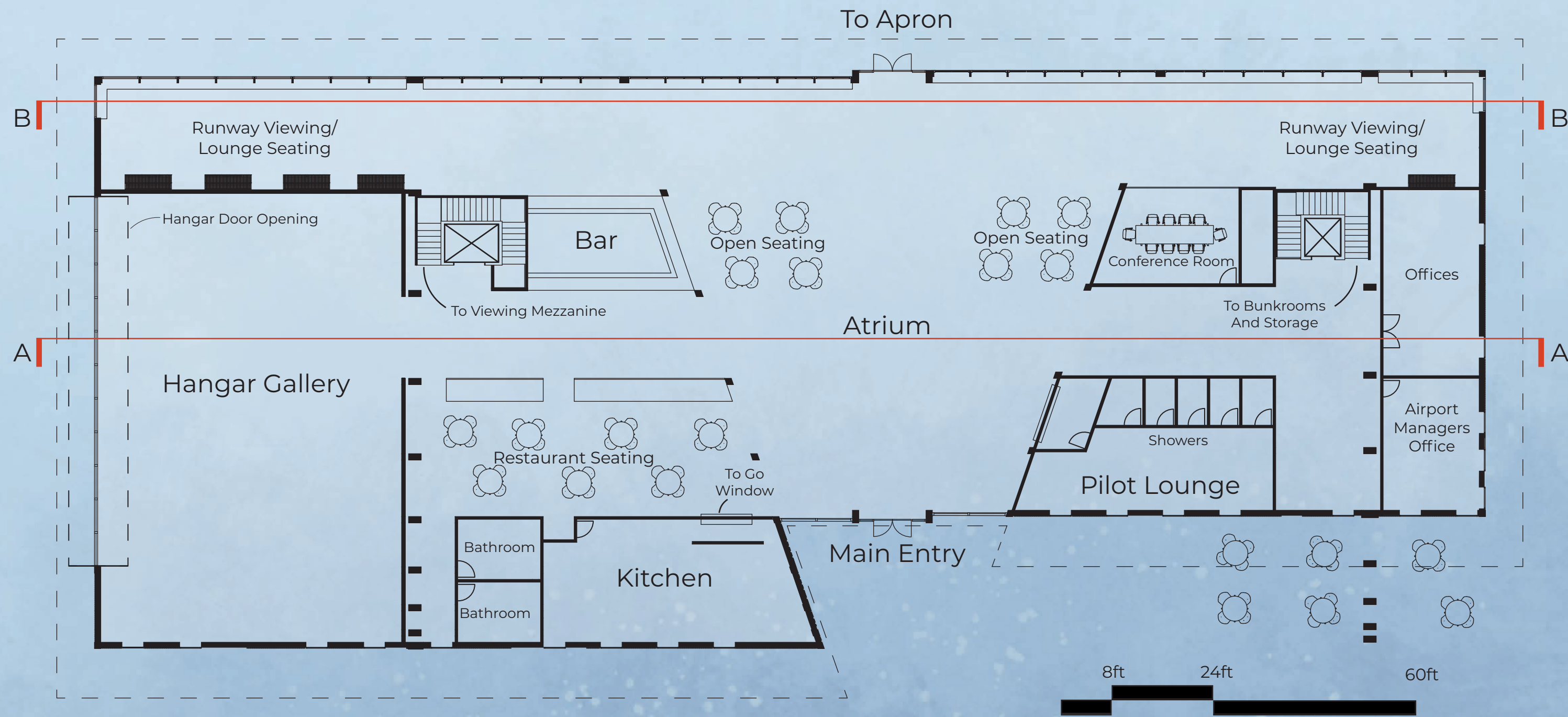

### Upper Mezzanine Floorplan

Scale: 1/16"=1'

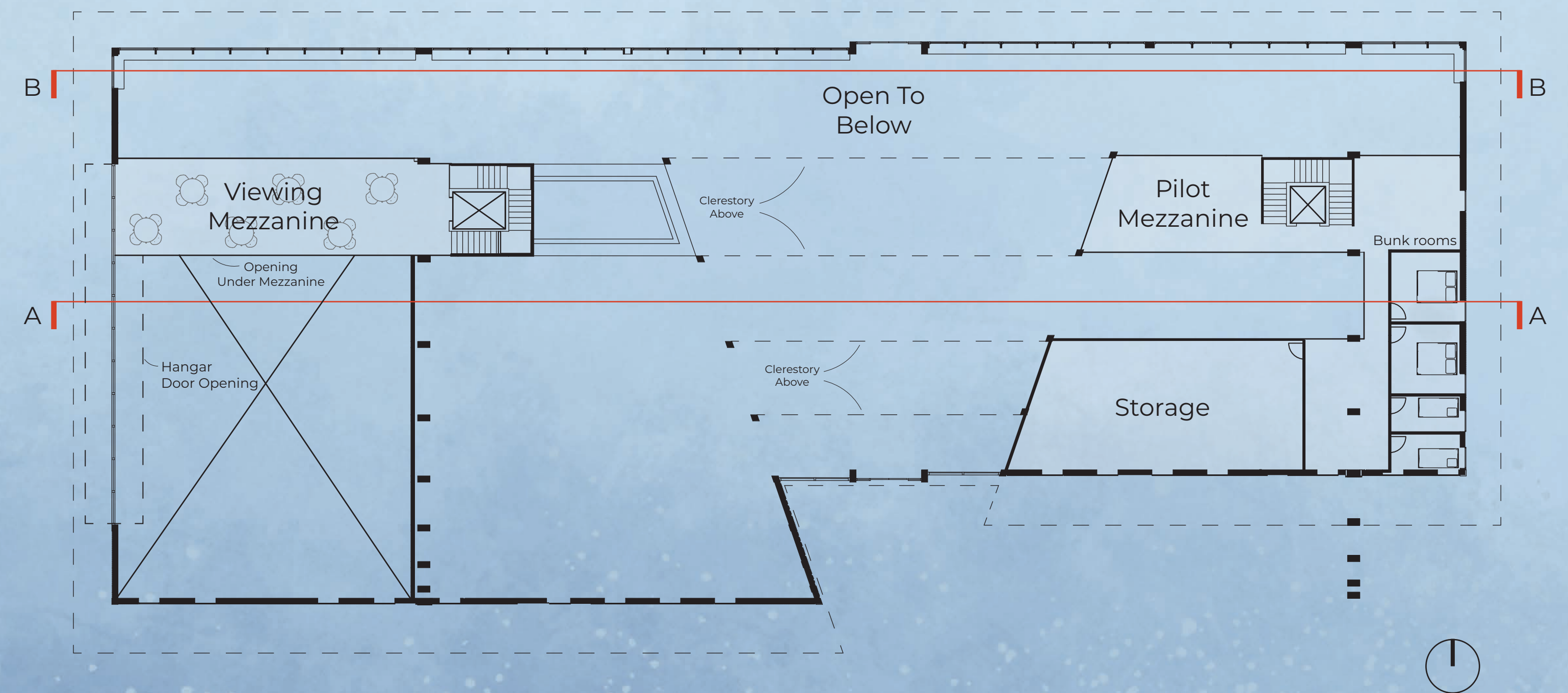

### Section A

Scale: 1/8"=1'



### Structure/Program

The buildings program follows the layout of the structure. The west side focuses on the civic and the east the pilots. The community comes together in the center atrium, as a space to gather and enjoy aviation together.

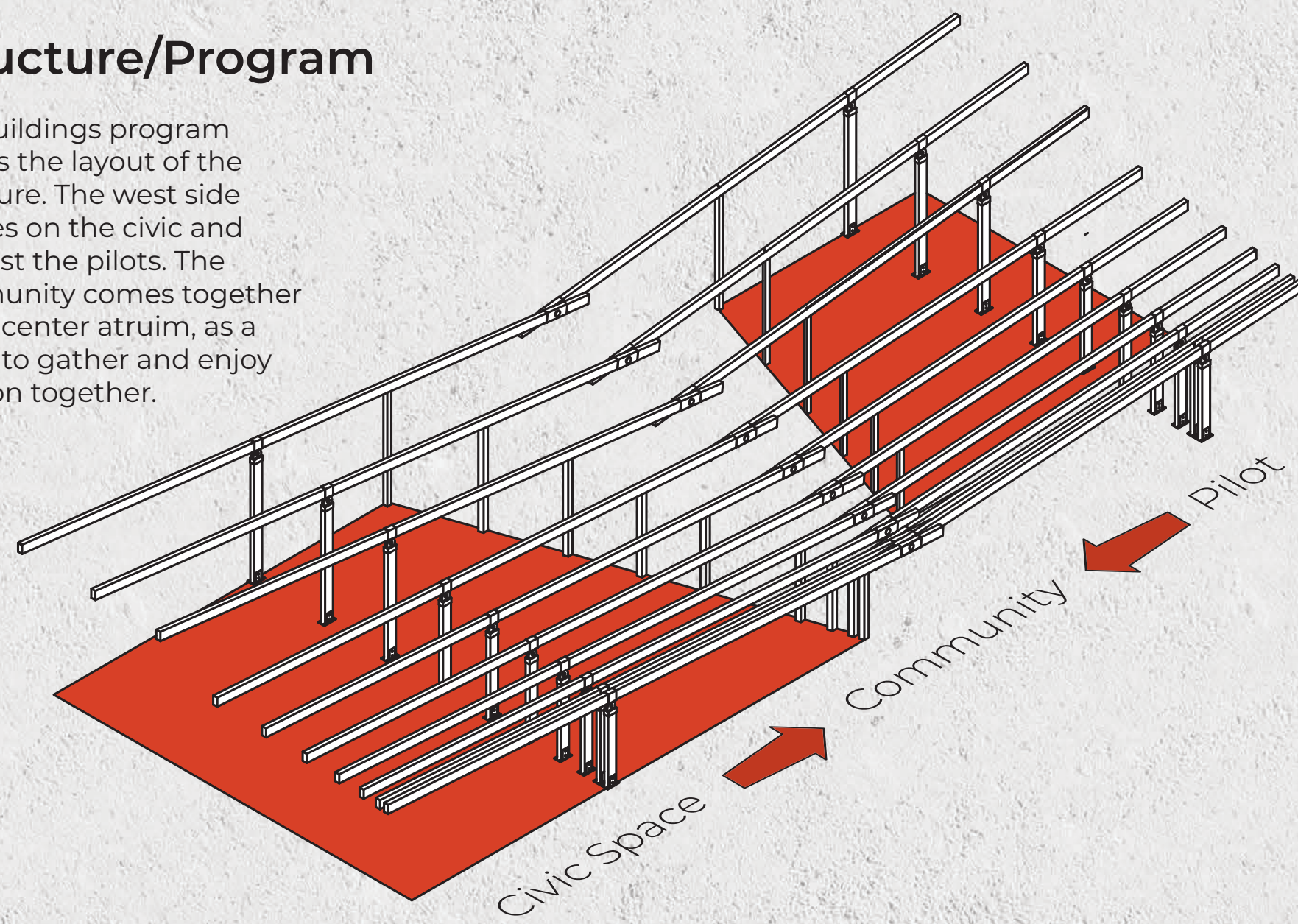

### Circulation

The circulation is based on a simple axis. The main axis runs straight through, with a view from the front approach all the way through to the runway apron. Two vertical circulation shafts lead to upper mezzanines on the east and west wings.

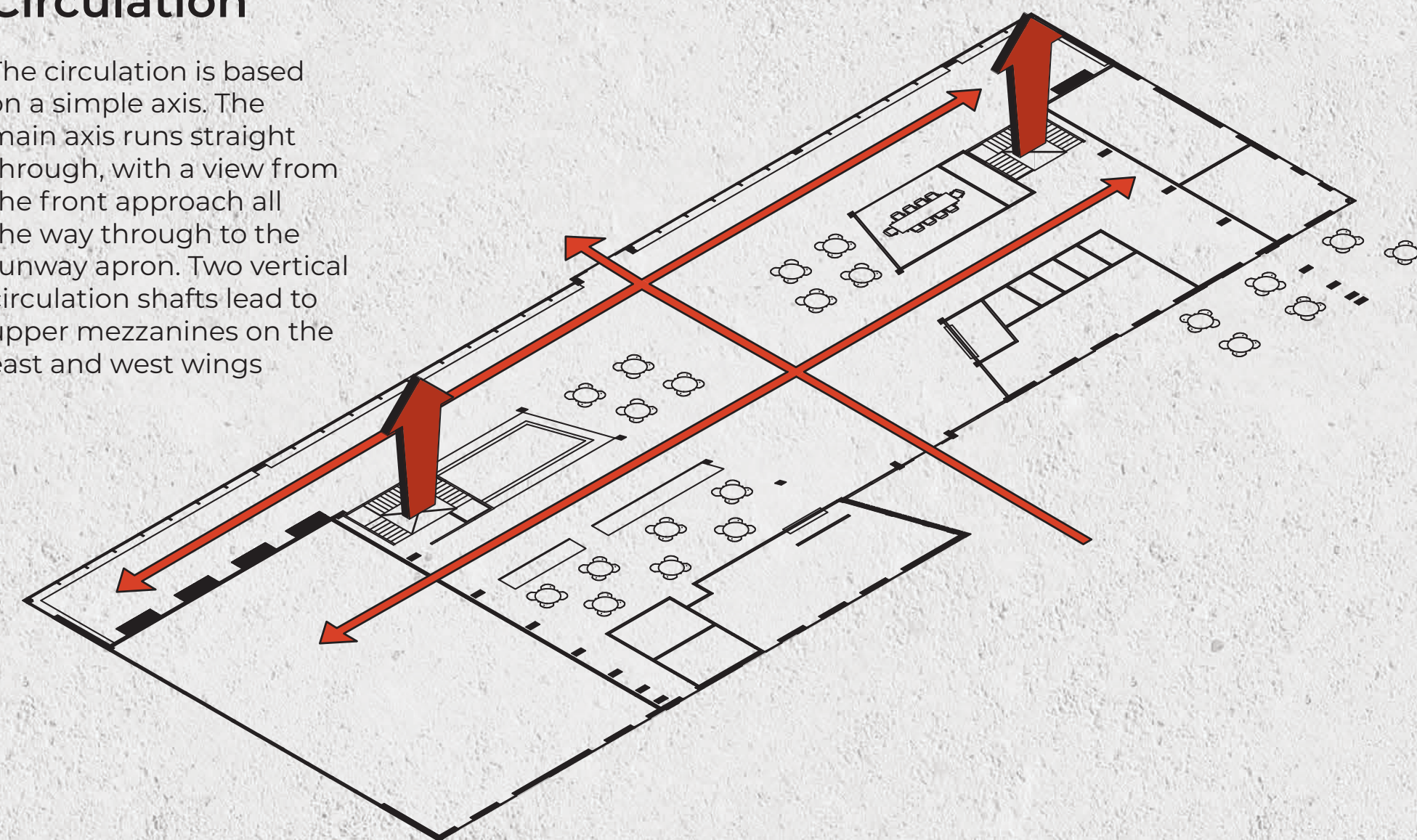

### Solar Collection

The 4 roof planes are angled in correlation with the summer sun to maximize solar collection. PV Solar panels are arranged on each plane and can change their angle based on the current seasonal need. The differing angles of the roof allow for solar collection while managing the reflection that could affect passing aircraft.

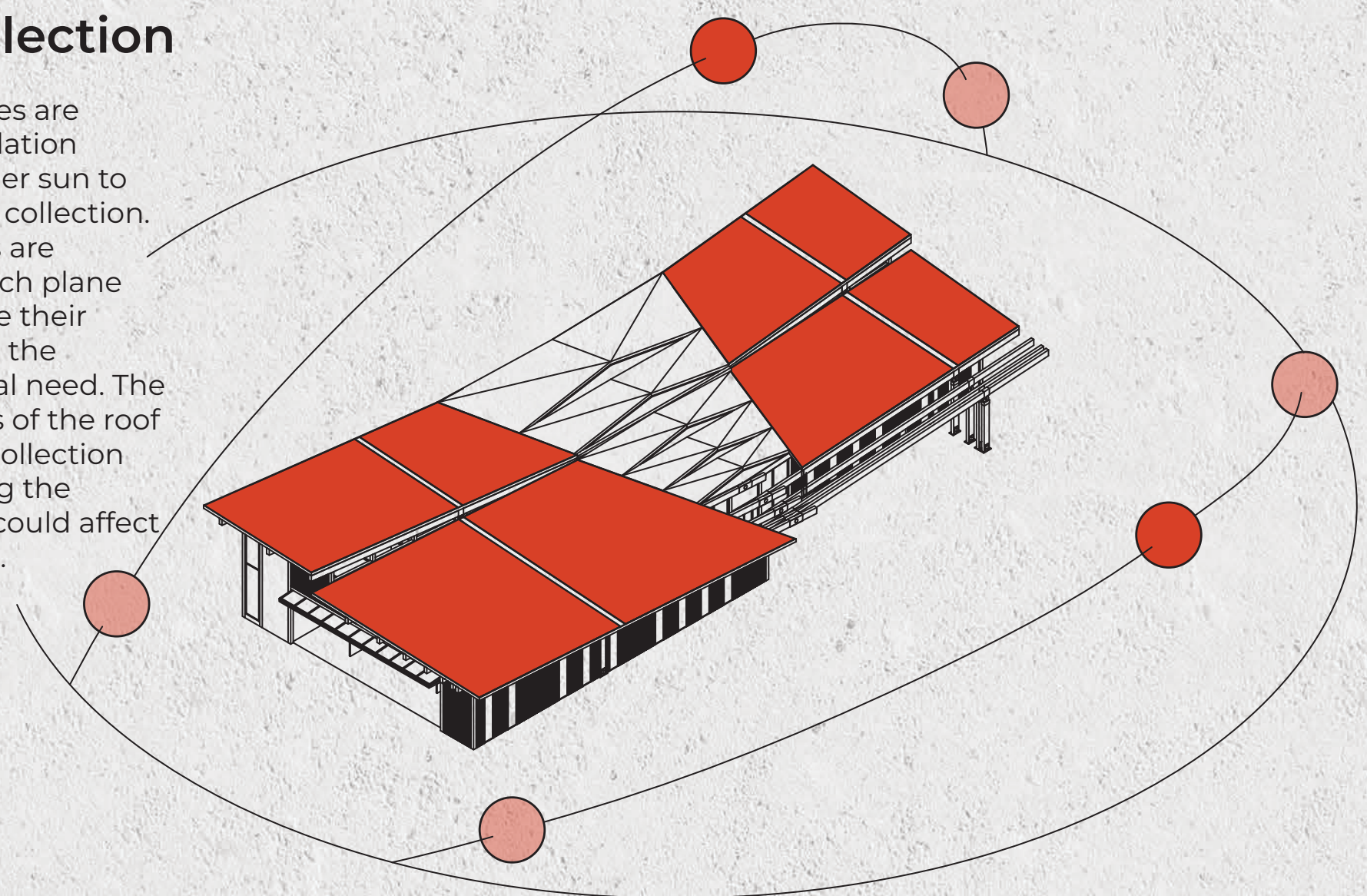

**Wall Section**

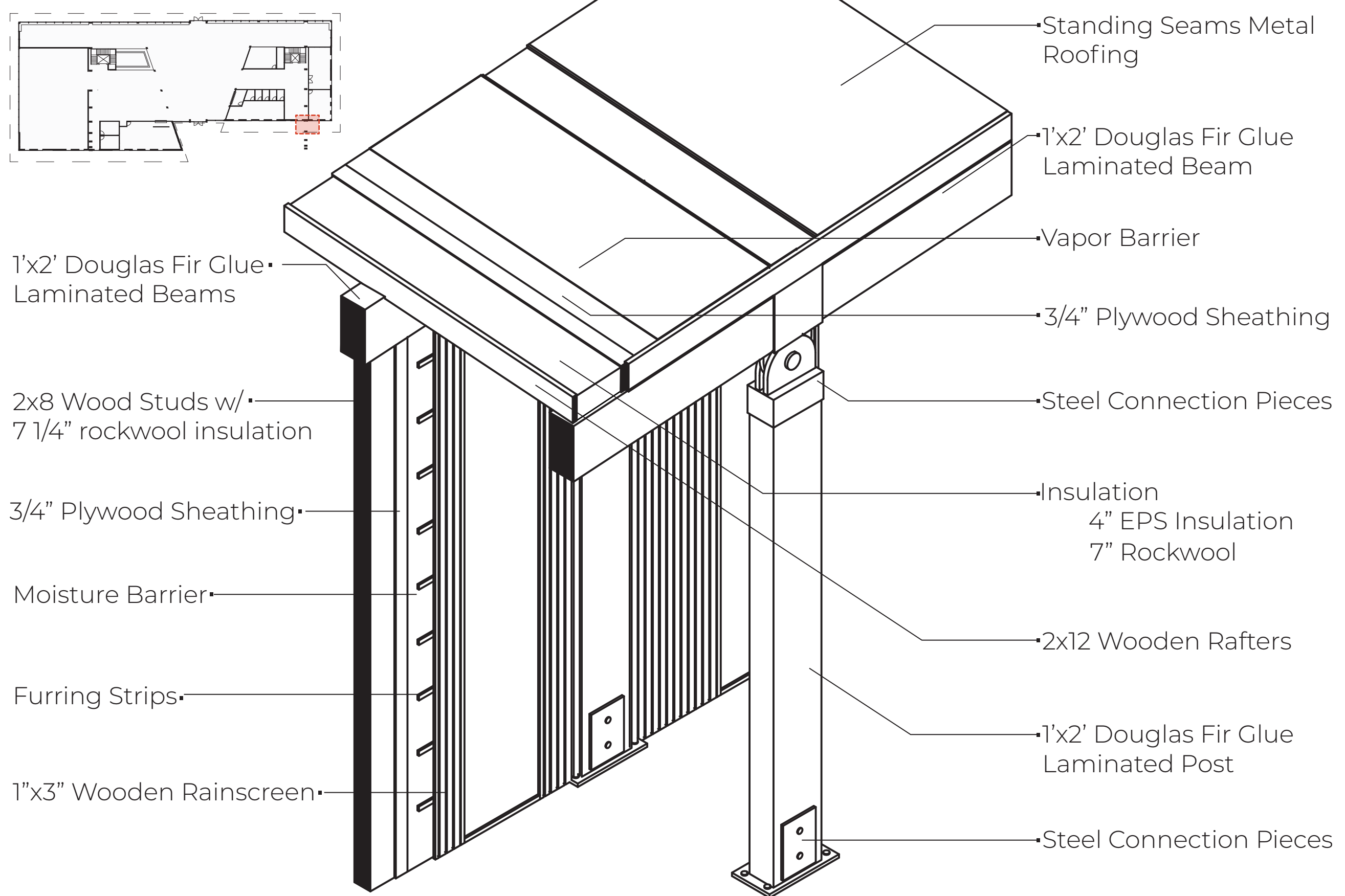

**Hangar Gallery**

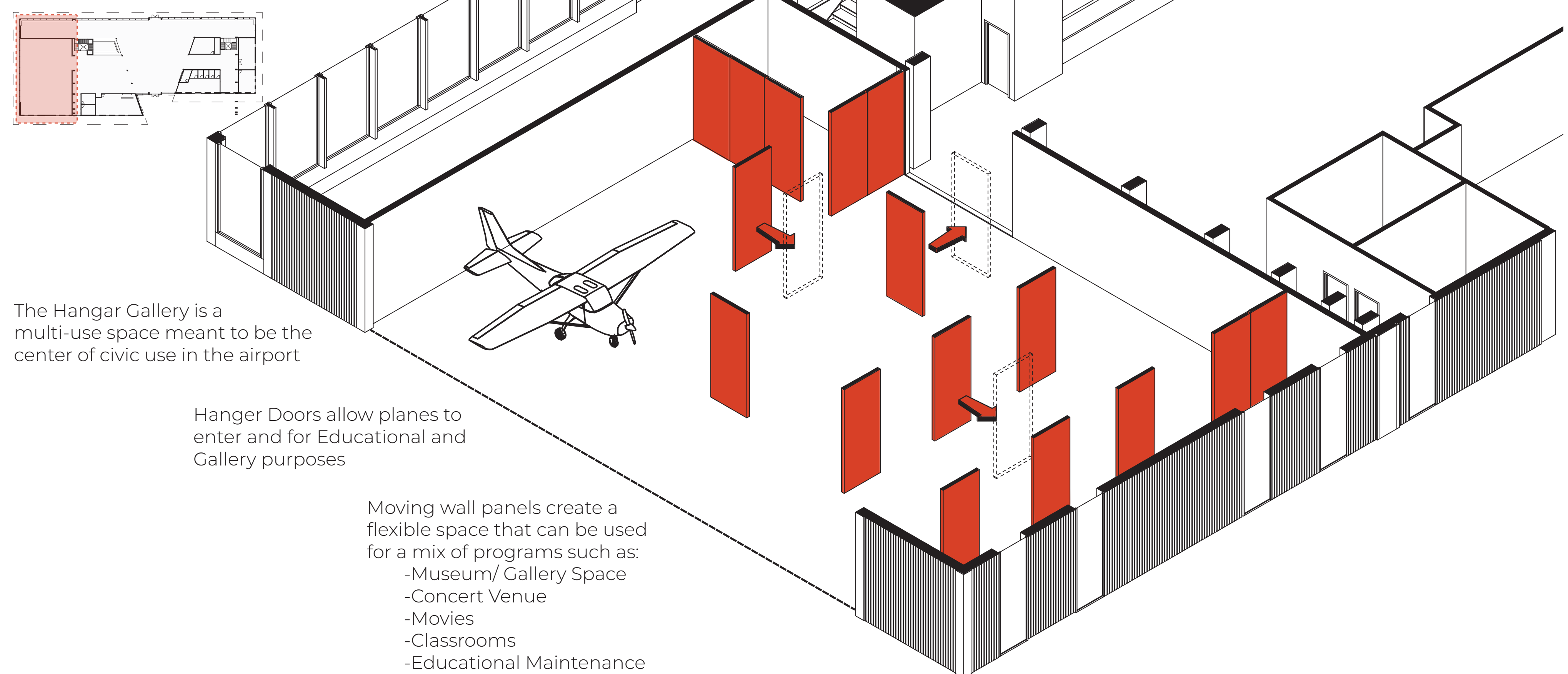

**Section B**

Scale: 1/8"=1'

